

1 Before each wash cycle: Check that drum doors are properly closed. If the yellow plastic roller is slipped under the opposite door, call Electrolux Professional technical service. **Do not start a washing program.**



6 Clean the soap box.



2 Before each wash cycle: Check that no linen is pinched by the door hooks or between drum doors and frame.



7 Visually check the drum door hooks. If deformation or premature wear (cracks), call Electrolux Professional technical service. **Do not start a washing program.**



3 Check that the opening safety device of the drum doors is working correctly. If the doors opens when pushing the lower door, call Electrolux Professional technical service. **Do not start a washing program.**



8 Use a brass brush to remove lint from the inner drum door springs, both from inside and outside.



4 Check that the Emergency stop buttons works properly.



9 Clean the outer surfaces of the machine with a soft cloth.



5 Check that the outer door is locked after the door has been closed.



10 Check the water inlet hoses for leakage, aspect and wear.



Cleaning external surfaces

Wash the external surfaces with warm, soapy water. Avoid using detergents containing abrasive substances, steel wool, brushes or steel scrapers. Rinse with a damp cloth and dry carefully. Avoid using chlorine or ammonia-based products. Clean the control panel with a soft cloth dampened with water and, if necessary with neutral detergent. Do not wash the equipment with direct or high pressure jets of water. With the aim of reducing the emission of polluting substances into the atmosphere, it is advisable to clean the equipment (externally and, when necessary, internally) with products that have a biodegradability exceeding 90%. **Electrolux Professional strongly recommends to use Electrolux Professional approved cleaning agents, rinse and descaling agents to obtain better results and maintain product efficiency over time.** Damages caused by cleaning, as a consequence of use of not approved cleaning agents, rinse and descaling, will be excluded by the warranty.

The operations described must be performed wearing the needed Personal Protection Equipment. Refer to the User Manual.

Instructions for use

NOTE! Read the User Manual before operating the machine. Pay special attention to chapters **Safety**, **Preparation** and **Operation**. Before loading the washer, check the clothes, empty the pockets, close zippers and buttons. Do not wash damaged clothes, repair them first.



Do not overload the machine.
The maximum load in this machine is 90 kg dry linen. Each compartment can carry a maximum load of 45 kg dry linen.



Load the machine correctly.
Even if the machine is not loaded to its full capacity, the load must always be evenly distributed between each compartment. See User Manual chapter **Preparation**

Before each wash cycle:

Check that no linen is pinched by the door hooks or between drum doors and frame.

Check that drum doors are properly closed. If the yellow plastic roller is slipped under the opposite door, call Electrolux Professional technical service.

Do not start a washing program.

Drum positioning and door unlocking:

Position the first drum compartment in front of the outer door with the **Drum position** button and unlock the door with the **Door unlocking** button.

Close the door after unloading, and do the same operation for second drum compartment. If the **Rapid advance** function is used during a wash cycle, the linen can only be unloaded on the Loading side.

Launching a program on the basis of an existing program:

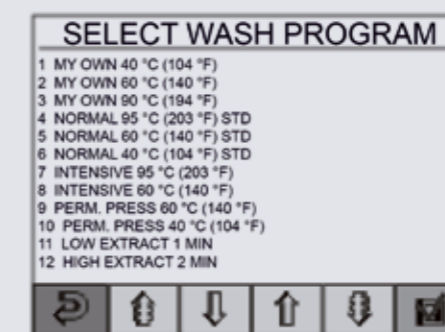
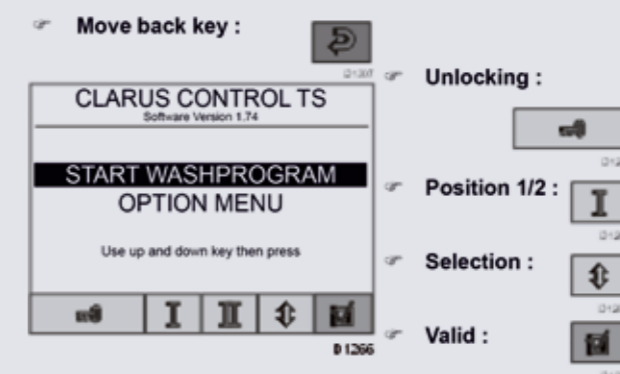

Allows to choose the program :



Previous and following page :



Anomaly	Description	Instructions to User
00. MACHINE HALTED	The machine has been halted	<ul style="list-style-type: none"> Press the Validation checkmark to resume operation.
01. EMERGENCY STOP ACTIVE	Emergency Stop button activated	<ul style="list-style-type: none"> Remedy the reason for the emergency stop button being activated. Release the activated emergency stop button by turning it clockwise. Press the Validation checkmark to resume operation. If persistent, contact authorized service
02. NO AIR PRESSURE	Too low pressure in compressed air system	<ul style="list-style-type: none"> Check compressed air is supplied to the machine and no obvious air leakage is at hand. Press the Validation checkmark to resume operation. If persistent, contact authorized service
03. I/O COM ERROR	Communication between I/O board and Display board interrupted	<ul style="list-style-type: none"> Press the Validation checkmark to resume operation. If persistent, contact authorized service
09. DRUM INDEX NOT FOUND	Indexing lever position is incorrect	<ul style="list-style-type: none"> Press the Validation checkmark to resume operation. If persistent, contact authorized service
10. NO WATER	Water level is not reached within set time	<ul style="list-style-type: none"> Check that water taps to the machine are open. Check that compressed air is supplied to the machine and no obvious air leakage is at hand. Press the Validation checkmark to resume operation. If persistent, contact authorized service
24. UNBALANCE	Unbalance sensor activated	<ul style="list-style-type: none"> Press the Validation checkmark to resume operation. Check that the two drum compartments are loaded with the same weight of dry linen. If persistent, contact authorized service
29. OVER WEIGHT	The machine is loaded above its maximum capacity	<ul style="list-style-type: none"> Check that the total weight of linen in both drum compartments is not exceeding the maximum weight for the machine. Make sure the load is distributed evenly in both compartments. If persistent, contact authorized service



Performance maintenance programmes

In order to ensure the safety and performance of your equipment, it is recommended that service is undertaken by Electrolux Professional authorised engineers every 12 months, in accordance with the manufacturer indications. Please contact your local Electrolux Professional Service Centre for details on the maintenance agreement.

Suggested for you

For more Accessories & Consumables please look at our Catalogues or contact our Electrolux Professional Service Partner.



0W1XFY
Canvas Trolley
RV-74 - 200 lt



0W1Y2F
Stainless Steel
Trolley BV-220/BV
131 lt



0W1Y2B
Spring Trolley
229 lt



Working Table
0W1Y2H
1000 x 700 x 850
0W1Y2J
1500 x 700 x 850
0W1Y2K
2000 x 700 x 850



0W7S9D
All purpose
Microfibre cloth



Water soluble bags (25 bags)
0W1XXU (S)
660 x 840 mm
0W1XXV (M)
710 x 990 mm
0W1XXW (L)
910 x 990 mm