

## 400 Line 1 Door Freezer (-15/-24) - Stainless steel, 60Hz (Marine)

ITEM # \_\_\_\_\_

MODEL # \_\_\_\_\_

NAME # \_\_\_\_\_

SIS # \_\_\_\_\_

AIA # \_\_\_\_\_



730102 (R04FSF4M)

1-door freezer, 400lt, -15-24°  
C, stainless steel, 60Hz,  
marine

### Short Form Specification

Item No. \_\_\_\_\_

Exterior in stainless steel. Interior in white High Impact Polystyrene with rounded corners and 45mm thick insulation. Right hinged full door with lock and heated frame, reversible on-site. Built-in refrigeration unit; manual defrost; digital control and temperature display; multiple evaporating grids. For ambient temperatures up to 38°C. HCFC, CFC and HFC free insulation and R404a refrigerant gas. Supplied with n. 4 evaporating grids.

### Main Features

- Digital control panel allowing the easy and precise setting and control of the internal temperature.
- Shelf runners are thermoformed and are incorporated in the internal structure to be easily cleanable.
- CFC and HCFC free (ecological refrigerant type: R404a, gas in foam: cyclopentane).
- Whole interior cell with rounded corners is white thermoformed polystyrene, which is impact resistant.
- Very quiet operation.
- No joints whatsoever to eliminate dirt traps.
- Simple refrigeration system easily accessible from the rear of the units.
- Suitable for use in ambient temperatures of up to 38 ° C.
- Connectivity ready for real time access to connected appliances from remote and data monitoring (requires optional accessory).

### Construction

- Developed and produced in ISO 9001 and ISO 14001 certified factory.
- All models in range are finished in top quality materials to aid durability.

### Optional Accessories

- Kit of wheels for 400L refrigerators PNC 880348
- PVC container with false bottom for 400L PNC 881072

APPROVAL: \_\_\_\_\_

### Front

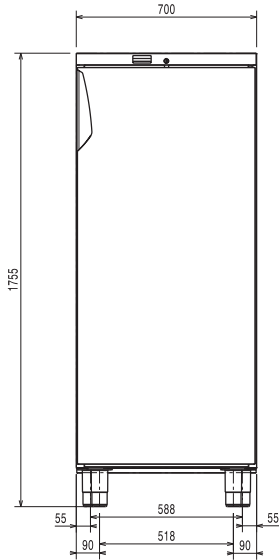

### Side

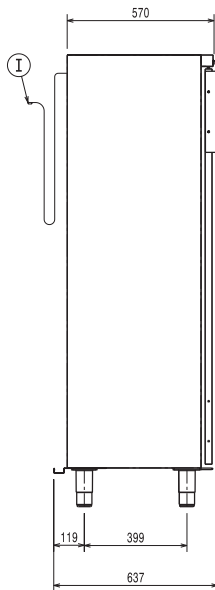

EI = Electrical inlet (power)

### Top

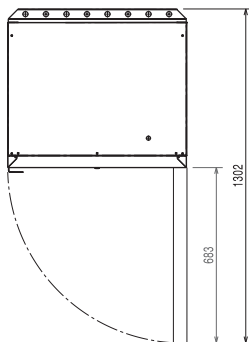

### Electric

Supply voltage:

730102 (R04FSF4M)

220-230 V/1 ph/60 Hz

Electrical power max.:

0.48 kW

### Key Information:

Gross capacity:	400 lt
N° of doors:	1
Door hinges:	
External dimensions, Width:	700 mm
External dimensions, Height:	1755 mm
External dimensions, Depth:	620 mm
External dimensions, Depth with Doors Open:	1310 mm
Noise level:	56 dBA
Type of external material:	Stainless Steel
Type of internal material:	Polystyrene
External side panels:	Stainless Steel
External top panels:	Stainless Steel
External door material:	Stainless Steel
Internal panels material:	Polystyrene
Internal side panels material:	Polystyrene

### Refrigeration Data

Control type:	Digital
Refrigerant type:	R404A
Refrigeration power:	712 W
Refrigeration power at evaporation temperature:	-23.3 °C
Refrigerant weight:	240 g
Operating temperature min.:	-24 °C
Operating temperature max.:	-15 °C
Operating mode:	Static
Cooling unit:	Built-In
Defrost type:	Manual