

## 400 Line 1 Glass Door Wine Refrigerator (+4/+19) - Black with wooden shelves

ITEM # \_\_\_\_\_

MODEL # \_\_\_\_\_

NAME # \_\_\_\_\_

SIS # \_\_\_\_\_

AIA # \_\_\_\_\_



729039 (A4P6SWB)

1-glass door wine refrigerator  
400lt, +4/+19°C, black finishing  
and smoked grey glass,  
wooden shelves

### Short Form Specification

Item No. \_\_\_\_\_

Exterior in black painted steel. Interior in grey High Impact Polystyrene with rounded corners and 45mm thick insulation. Right hinged "smoked grey" glass door with lock, reversible on-site. Built-in refrigeration unit; black control panel; electro-mechanical control; internal light. Cell temperatures: upper part +16/+19°C; +13/+15°C; middle part +10/+12°C; +7/+9°C; lower part +4/+7°C. For ambient temperatures up to 32°C. HCFC, CFC and HFC free insulation and R134a refrigerant gas.

Supplied with n. 3 wooden shelves 600x400mm and n. 1 grid 600x285mm PE coated.

APPROVAL: \_\_\_\_\_

### Main Features

- Attractive presentation through glass door and lighting.
- Different temperatures for different zones in the cavity to store different types of wines.
- Shelf runners are thermoformed and are incorporated in the internal structure to be easily cleanable.
- Whole interior cell with rounded corners is white thermoformed polystyrene, which is impact resistant.
- Model requires only 1 phase 230V supply and can be plugged straight into an existing power socket.
- Very quiet operation: noise level less than 55 dB (A).
- No joints whatsoever to eliminate dirt traps.
- Simple refrigeration system easily accessible from the rear of the units.
- Suitable for use in ambient temperatures of up to 32 °C.
- Model equipped with roll-bond plate that has a plate installed in the internal backside of the unit equipped with a special thermostat to avoid ice formation.

### Construction

- Developed and produced in ISO 9001 and ISO 14001 certified factory.
- All models in range are finished in top quality materials to aid durability.
- CFC and HCFC free (ecological refrigerant type: R134a, - gas in foam: cyclopentane).

### Included Accessories

- 1 of Kit of 3 wooden shelves for 400L wine PNC 880187 refrigerator

### Optional Accessories

- 3 rilsan grids for 400L wine refrigerator  PNC 880131

**Front**

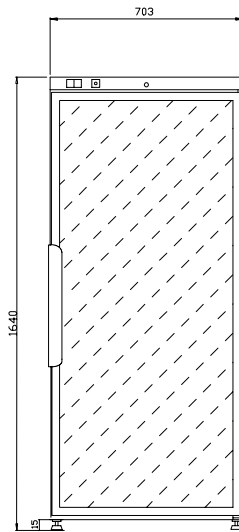

**Side**

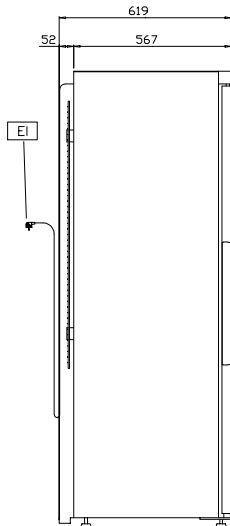

EI = Electrical inlet (power)

**Top**

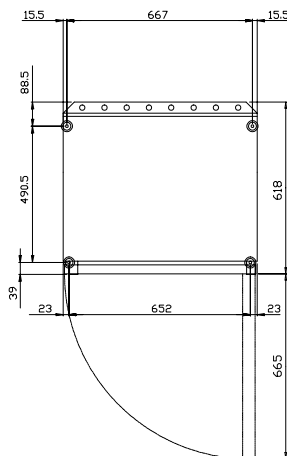

### Electric

|                                   |                  |                  |
|-----------------------------------|------------------|------------------|
| Supply voltage:                   | 729039 (A4P6SWB) | 230 V/1 ph/50 Hz |
| Electrical power max.:            |                  | 0.21 kW          |
| Defrost Power:                    |                  |                  |
| Current consumption:              |                  | 1.7 Amps         |
| Plug type:                        |                  | CE-SCHUKO        |
| Energy consumption (min,default): |                  | 0 - 0 kW/h       |

### Key Information:

|                                      |                    |
|--------------------------------------|--------------------|
| Gross capacity:                      | 400 lt             |
| Net Volume:                          |                    |
| Door hinges:                         |                    |
| External dimensions, Width:          | 700 mm             |
| External dimensions, Height:         | 1640 mm            |
| External dimensions, Depth:          | 620 mm             |
| Number and type of doors:            | 1 Glass            |
| Internal Dimensions (depth):         | 435 mm             |
| Internal Dimensions (height):        | 1450 mm            |
| Internal Dimensions (width):         | 610 mm             |
| Net weight:                          | 89 kg              |
| Shipping volume:                     | 0.9 m <sup>3</sup> |
| Height adjustment:                   | 0/0 mm             |
| Number and type of grids (included): | 3 - 600x400        |

### Refrigeration Data

|                                                 |            |
|-------------------------------------------------|------------|
| Control type:                                   | Mechanical |
| Compressor power:                               | 1/5 hp     |
| Refrigerant type:                               | R134a      |
| GWP Index:                                      | 1430       |
| Refrigeration power:                            | 156 W      |
| Refrigeration power at evaporation temperature: | 0 °C       |
| Refrigerant weight:                             | 240 g      |
| Min/Max internal humidity:                      | 70/70      |
| Operating temperature min.:                     | 4 °C       |
| Operating temperature max.:                     | 19 °C      |
| Operating mode:                                 | Static     |

### Product Information (EU Regulation 2015/1094)

|                                      |  |
|--------------------------------------|--|
| Energy Class:                        |  |
| Yearly and daily energy consumption: |  |
| Climate class:                       |  |
| Energy Efficiency Index (EEI):       |  |
| Type of model:                       |  |

400 Line  
1 Glass Door Wine Refrigerator (+4/+19) - Black with wooden shelves

The company reserves the right to make modifications to the products without prior notice. All information correct at time of printing.