

## Blast Chiller Freezers Crosswise Blast Chiller-Freezer Crosswise - 80kg 10GN 2/1 (R452A)

ITEM # \_\_\_\_\_

MODEL # \_\_\_\_\_

NAME # \_\_\_\_\_

SIS # \_\_\_\_\_

AIA # \_\_\_\_\_



729543 (ACBCFA080SE)

CRIO Chill Tech blast chiller & freezer 80kg, compatible with 10x2/1GN convection oven - R452A

### Short Form Specification

#### Item No.

Blast chiller/freezer with digital temperature and time display. For 10 GN 2/1 or 600x400 mm trays (h = 65 mm). Load capacity: chilling 80 kg; freezing 40 kg. Automatic detection of food probe insertion. Automatic and Manual defrost. Blast chilling real remaining time estimation (A.R.T.E.). Turbo cooling function. Thawing function. HACCP and Service alarms with data logging. Connectivity ready. Operating air temperature: +10/-36°C. Single sensor food probe. Main components in 304 AISI stainless steel. Internal rounded corners and drain. Evaporator with antirust protection. Performances guaranteed at ambient temperature of +40°C. Cyclopentane insulation (HCFC, CFC and HFC free). R452a refrigerant gas (HCFC and CFC free). Built-in refrigeration unit.

### Main Features

- Blast Chilling cycle: 80 kg from 90°C up to 3°C in less than 90 minutes.
- Chilling cycle with automatic preset cycles:
  - Soft Chilling (air temperature 0°C), ideal for delicate food and small portions.
  - Hard Chilling (air temperature -12°C), ideal for solid food and whole pieces.
- Freezing cycle with automatic preset cycles (air temperature -36°C), ideal for all kind of food (raw, half or fully cooked).
- Turbo cooling: chiller works continuously at the desired temperature; ideal for continuous production.
- Thawing cycle (air temperature 7°C), ideal for defrosting food in a controlled and safe environment.
- Possibility to modify the cavity temperature in turbo cooling and thawing cycles.
- Remaining time estimation for probe-driven cycles based on artificial intelligence techniques (ARTE) for an easier planning of the activities.
- Single sensor core probe as standard.
- Control unit provides two large displays to read out: time, core temperature, cycle countdown, alarms, service information.
- On-board HACCP monitoring capable.
- Connectivity ready for real time access to connected appliances from remote and HACCP monitoring (requires optional accessory).
- Performance guaranteed at ambient temperatures of +40°C (Climatic class 5).
- Automatic and manual defrosting.
- Working temperature from +90°C to +3°C in chilling mode or to -36°C in freezing mode.

### Construction

- No water connections required.
- Ventilator swinging hinged panel for access to the evaporator for cleaning.
- Waste water can be plumbed into drain, but can also be collected in an optional waste container.
- Environmentally friendly: R452a as refrigerant gas.
- Built-in refrigeration unit.
- Removable magnetic door gasket with hygienic design.
- Main components in 304 AISI stainless steel.
- Evaporator with antirust protection.
- Hygienic shape with rounded corners (and drain for easy cleaning).
- Automatic heated door frame.
- Door reversible on site.
- Door stopper to keep the door open in order to avoid the formation of bad smells (kit available to be mounted on site, depending on preferred door hinge).
- 10 levels available. Usable with 10 x GN 2/1 or 600x800 mm trays (h = 65 mm).
- IP21 protection index.

### Sustainability

- Holding at +3 °C for chilling or -20 °C for freezing, automatically activated at the end of each cycle, to save energy and maintain the target temperature (manual

APPROVAL: \_\_\_\_\_

activation is also possible).

- High density polyurethane insulation, 60 mm tickness, HCFC free.



**Blast Chiller Freezers Crosswise  
Blast Chiller-Freezer Crosswise - 80kg 10GN 2/1 (R452A)**

The company reserves the right to make modifications to the products without prior notice. All information correct at time of printing.

### Included Accessories

- 1 of 1 single sensor probe for blast chiller and blast chillers&freezer PNC 880213

### Optional Accessories

- Base for 10 GN 2/1 slide-in rack support for 56 kg blast chiller/freezers PNC 880075
- Kit of HACCP advanced connection for blast chiller and blast chillers/freezers PNC 880183
- 1 single sensor probe for blast chiller and blast chillers&freezer PNC 880213
- 2 single sensor probes for blast chiller-freezer PNC 880214
- Rilsan grid 600x400mm PNC 880864
- Plastic coated rilsan grid 2/1GN PNC 881030
- 4 wheels for blast chiller freezer PNC 881284
- Pair of 1/1GN grids in 304 AISI PNC 921101
- Pair of 1/1GN AISI 304 grids PNC 922017
- AISI 304 stainless steel grid, GN 1/1 PNC 922062
- AISI 304 stainless steel grid, GN 2/1 PNC 922076
- 80mm pitch side hangers for 10x2/1GN oven PNC 922117
- 60mm pitch side hangers for 10x2/1GN oven PNC 922123
- Trolley for 10x2/1GN roll-in rack PNC 922128
- Pair of 2/1 GN grids in 304 AISI PNC 922175
- Kit to convert to 10x2/1GN roll-in rack PNC 922202
- Pastry grid in AISI 304 stainless steel, 400x600mm PNC 922264
- IoT module for CRIO Chill Tech blast chiller/freezers PNC 922419

**Front**

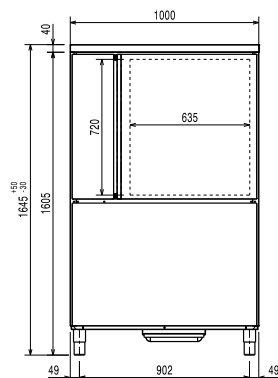

**Side**

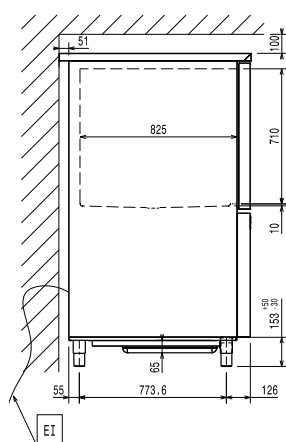

D = Drain  
EI = Electrical inlet (power)

**Top**

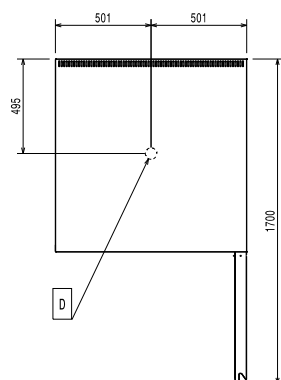

### Electric

Supply voltage:  
729543 (ACBCFA080SE) 380-415 V/3N ph/50 Hz  
Electrical power max.: 3.4 kW

### Installation:

Clearance: 5 cm on sides and back.  
Please see and follow detailed installation instructions provided with the unit

### Capacity:

GN: 6 - 1/1 containers

### Key Information:

External dimensions, Width: 1000 mm  
External dimensions, Depth: 1006 mm  
External dimensions, Height: 1645 mm  
Net weight: 220 kg  
Shipping weight: 257 kg  
Shipping volume: 1.93 m<sup>3</sup>

### Refrigeration Data

Refrigeration power at evaporation temperature: -20 °C  
Condenser cooling type: AIR

### Product Information (EN17032 – Commission Regulation EU 2015/1095)

Chilling Cycle Time (+65°C to +10°C): 108 min  
Full load capacity (chilling): 80 kg  
Test performed in a test room at 30°C to chill/ freeze (+10°C/-18°C) a full load of 40mm deep trays filled with mashed potatoes evenly distributed up to a height of 35 mm at starting temperature between 65° and 80°C within 120/270min.

### Sustainability

Refrigerant type: R452A  
GWP Index: 2141  
Refrigeration power:  
Refrigerant weight: 3700 g  
Energy consumption, cycle (chilling): 0.0767 kWh/kg