



322065 (F11C4KW02S)

Refrigerated well on cupboard, static with fan (4 GN container capacity) with wheels, overshelf with LED lights and two stainless steel tray sliders, H=750mm (Nordic)

Main Features

- Suitable for GN 1/1 containers with a maximum height of 150 mm.
- Perfect compact design makes it ideal for space saving environments.
- CB and CE certified by a third party notified body.
- Soft closing doors on operator side.
- Underneath ambient cupboard with doors ideal for extra storage.
- Available options with online configurator: colors, tray sliders, overshelves, feet/wheels with desired diameter, height 750mm for kids.
- Overshelf equipped with LED lights.
- Optional plinth can be installed to cover the feet or the wheels.
- AISI 304 Tray slider in flush mounted stainless steel is installed on long sides and they can also be folded down to facilitate passage of the units through doorways.
- Ideal for servery lines without an operator.
- Unit mounted on 125 mm wheels 2 swivel and 2 with brakes.
- Stylish A type overshelf designed for extra increased visibility on the surface for charming food display.
- Curved glass.
- Designed to serve the food in gastronorm containers.
- Precise temperature control and setting at 0,1°C .
- As standard the product comes with digitally controlled thermostat which is in line of HACCP norms and provides visual alarm as a warning of the increasing or decreasing temperatures.
- Food introduced at the correct temperature maintains its core temperature according to Afnor Standards.
- Automatic defrosting guarantees evaporators clearance and efficient well cooling.
- A constant flow of cold air circulating through the containers guarantees the correct food temperatures. Temperature uniformity and fast cool down times are guaranteed thanks to powerful radial booster fans. Cylindrical stainless steel air diffusers provides a constant air circulation.
- Available dimensions: 2, 3, 4 GN.
- Thanks to the sleek, minimalist glass structure, food and dust does not get trapped and the cleaning is made easier.



Construction

- Well bottom is inclined to facilitate water drainage.
- Overshelf in complete AISI 304.
- Top in AISI 304.
- Sturdy construction with laminated panelings on 4 sides.
- Well in 304 AISI stainless steel with rounded corners to facilitate cleaning operations. The well is also equipped with a drain hole.
- Electronic control with temperature display.
- IPx2 water protection.
- The bottom is equipped with copper tubes to ensure proper cooling, with this system the air touches the cold surface and gets cooled. Then cooled air is being distributed with radial booster fans.

Sustainability

- Hydrocarbon refrigerant gas R290 for the lowest environmental impact (GWP=3) - CFC and HCFC free.
- High-density expanded polyurethane foam with cyclopentane guarantees excellent well insulation to reduce energy dispersion.
- 84% faster cool down time (than static refrigerated well) reduces energy consumption by allowing the operator to switch the machines on only when needed.

Optional Accessories

| PNC Code | Description |
|-------------------------------|--|
| Feet, wheels and ramps | |
| 800002 | Kit 4 height adjustable flanged feet, Marine |
| Kicking strips | |
| 800008 | Kicking strip for 4 GN units (not for Bain-Marie with separated wells) |

Recommended Detergents

| PNC Code | Description |
|----------|---|
| 0S2881 | S01 STAINLESS STEEL SURFACE POLISHER; 6 BOTTLES X 750ML C/T |
| 0S2883 | S03 ALCOHOL BASE DETERGENT; 6 BOTTLES X 750ML; ADR&IMDG&IATA Limited Quantity |
| 0S2884 | S04 GLASSES & HARD SURFACES CLEANERS; 6 BOTTLES X 750ML |
| 0S3257 | S05 - MULTIPURPOSE DEGREASER; 6PCS X 750ML; ADR&IMDG Limited Quantity |



Technical specifications

Electric

| | |
|------------------------|-----------------------|
| Supply voltage: | 220-240 V/1N ph/50 Hz |
| Electrical power max.: | 0.59 kW |

Key Information:

| | |
|------------------------------|---------------------|
| N° of doors: | 2 |
| External dimensions, Width: | 1420 mm |
| External dimensions, Depth: | 1180 mm |
| External dimensions, Height: | 1154 mm |
| Net weight: | 158.5 kg |
| Shipping height: | 1184 mm |
| Shipping width: | 899 mm |
| Shipping depth: | 1460 mm |
| Shipping volume: | 1.55 m ³ |
| Set temperature: | -10 / 0 °C |
| Top temperature: | -10 / 0 °C |

Sustainability

| | |
|--------------|--------|
| Noise level: | 64 dBA |
|--------------|--------|

Front

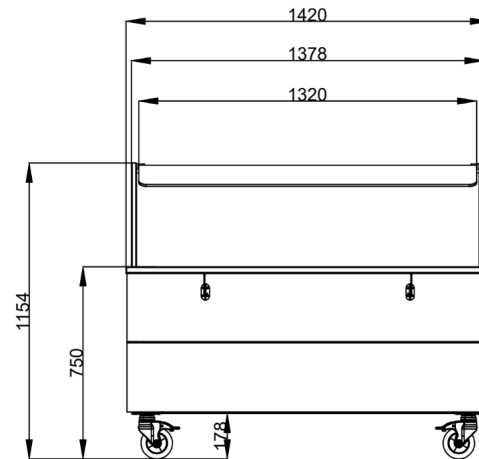

Side

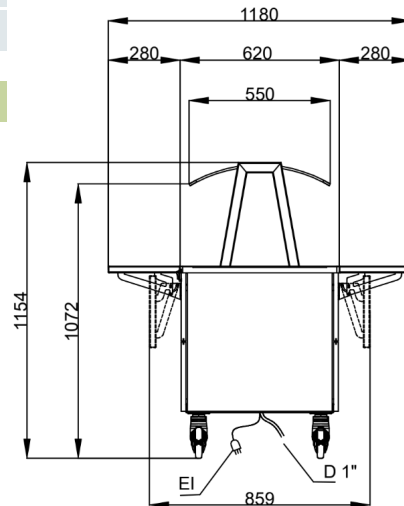

Top

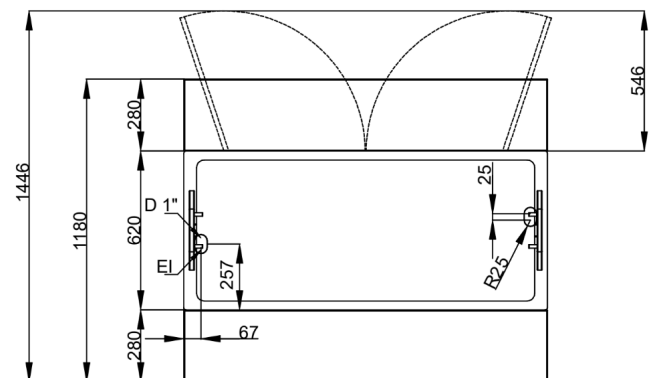

D = Drain

EI = Electrical inlet (power)



Find out more:
ISO Certificates
Electrolux Professional Recognitions

The company reserves the right to make modifications to the products without prior notice. All information correct at time of printing.

2026/06/09

3/3