

371014 (E7ECED2R00)

2-Hot Plate (2,6 kW each) electric Boiling Top

371126 (E7ECED2R0N)

2-Hot Plate (2,6 kW each) electric Boiling Top

Main Features

- IPx4 water protection.
- The special design of the control knob system guarantees against water infiltration.
- The two 2.6kW cast-iron plates are hermetically sealed to the one-piece top.
- Unit to be mounted on open base cupboards, bridging supports or cantilever systems.
- Suitable for countertop installation.

Construction

- Model has right-angled side edges to allow flush fitting joints between units, eliminating gaps and possible dirt traps.
- One piece pressed 1.5 mm work top in Stainless steel.
- External panel in Stainless Steel with Scotch Brite finish.

Optional Accessories

PNC Code	Description
Baskets	
921691	1 full size basket for 14/15lt fryers (only for 371126)
Bridge supports	
206137	Support for bridge type installation, 800mm
206138	Support for bridge type installation, 1000mm
206139	Support for bridge type installation, 1200mm
206140	Support for bridge type installation, 1400mm
206141	Support for bridge type installation, 1600mm
206154	Support for bridge type installation, 400mm



PNC Code	Description
Chimney upstands	
206303	Chimney upstand, 400mm
206400	Chimney grid net, 400mm (700XP/900)
Handrails	
206307	Right and left side handrails
206308	Back handrail 800 mm
216046	Frontal handrail, 400mm
216047	Frontal handrail, 800mm
216049	Frontal handrail, 1200mm
216050	Frontal handrail, 1600mm
216185	Large handrail - portioning shelf, 400mm
216186	Large handrail - portioning shelf, 800mm (only for 371126)
Installation solutions	
206086	Junction sealing kit
Panels	
216277	2 side covering panels for top appliances
Water taps	
206289	Water column with swivel arm (water column extension not included)
206291	Water column extension for 700 line



Technical specifications

371014 371126

Front

Electric

Supply voltage:	380-400 V/3 ph/50-60 Hz	230 V/3 ph/50/60 Hz
Total Watts:	5.2 kW	5.2 kW
Predisposed for:		

Key Information:

External dimensions, Width:	400 mm	400 mm
External dimensions, Depth:	730 mm	730 mm
External dimensions, Height:	250 mm	250 mm
Net weight:	20 kg	20 kg
Shipping weight:	23.75 kg	24 kg
Shipping height:	520 mm	540 mm
Shipping width:	460 mm	460 mm
Shipping depth:	800 mm	820 mm
Shipping volume:	0.19 m ³	0.2 m ³
Certification group:	EH72T	N7CE1
Front Plates Power:	2.6 - 0 kW	2.6 - 0 kW
Back Plates Power:	2.6 - 0 kW	2.6 - 0 kW
Front Plates dimensions:	Ø 230	Ø 230
Back Plates dimensions:	Ø 230	Ø 230

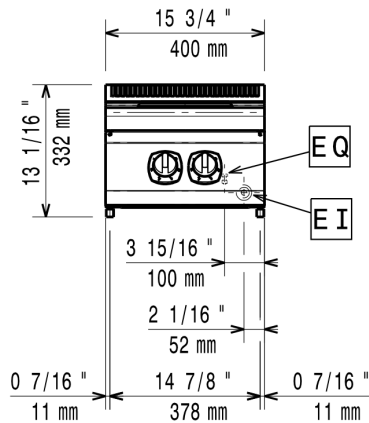

Side

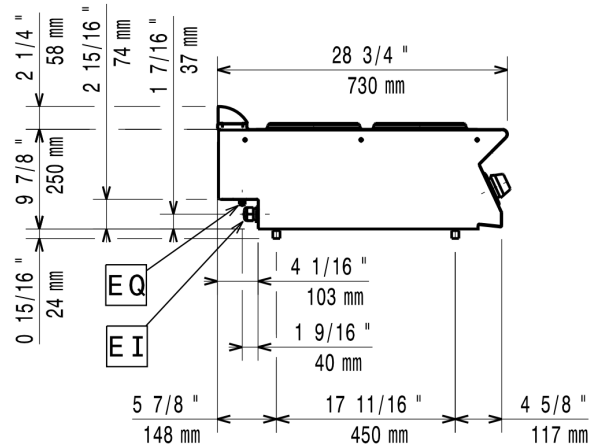

Top

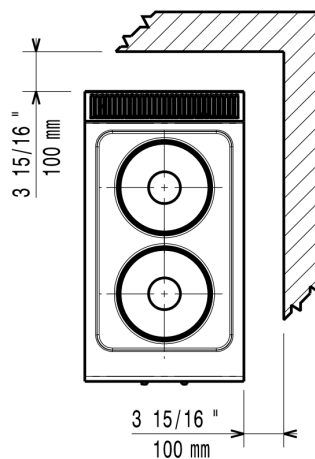

EI = Electrical inlet (power)

EQ = Equipotential screw



Find out more:
ISO Certificates
Electrolux Professional Recognitions

The company reserves the right to make modifications to the products without prior notice. All information correct at time of printing.

24/02/2026

3/3