

371026 (E7IREH40E0)

4-zone (2,2 kW each) infrared cooking Range on electric Oven (6 kW)

Main Features

- Base compartment consists of an electric standard oven with thick oven door for heat insulation, positioned beneath the base plate.
- Ceramic glass top cooking surface with 4 infrared heating zones 6 mm thick.
- Immediate heat transfer from cooking top to pan.
- IPx4 water protection.
- Low heat dissipation to the kitchen.
- Oven thermostat adjustable from 140 °C to 300 °C.
- The circular concentric heating sections measuring 230 mm give uniform heat also to the largest pan.
- The cooking top is sealed to prevent infiltration inside the unit
- The smooth glass-ceramic surface can be quickly and easily cleaned, thus providing maximum hygiene.
- Warning light to indicate residual surface heat
- Stainless steel oven chamber with 3 levels of runners to accommodate 2/1 GN shelves (2 steam pans).
- Heating via ultra high powered heating elements.

Construction

- Model has right-angled side edges to allow flush fitting joints between units, eliminating gaps and possible dirt traps.
- One piece pressed 1.5 mm work top in Stainless steel.
- All exterior panels in Stainless Steel with Scotch Brite finishing.

Sustainability

- Energy regulation of each zone.

Included Accessories

| PNC Code | Description | Quantity |
|----------|-----------------------------------|----------|
| 164250 | GN2/1 chrome grid for static oven | 1 |



Optional Accessories

| PNC Code | Description |
|------------------------------------|---|
| Chimney upstands | |
| 206304 | Chimney upstand, 800mm |
| 206400 | Chimney grid net, 400mm (700XP/900) |
| Containers, trays and grids | |
| 164250 | GN2/1 chrome grid for static oven |
| 206415 | Stainless steel grids with drain shape for free standing wide top grills (700XP) |
| Feet, wheels and ramps | |
| 206135 | Kit 4 wheels - 2 swivelling with brake - it is mandatory to install Base support and wheels |
| 206136 | Flanged feet kit |
| 206210 | Kit 4 feet for concrete installation (not for 900 line free standing grill) |
| 206367 | Base support for feet or wheels - 800mm (700/900) |
| 206368 | Base support for feet or wheels - 1200mm (700/900) |
| 206369 | Base support for feet or wheels - 1600mm (700/900) |
| 206370 | Base support for feet or wheels - 2000mm (700/900) |
| Handrails | |
| 206307 | Right and left side handrails |
| 206308 | Back handrail 800 mm |
| 216047 | Frontal handrail, 800mm |
| 216049 | Frontal handrail, 1200mm |
| 216050 | Frontal handrail, 1600mm |
| 216186 | Large handrail - portioning shelf, 800mm |
| Installation solutions | |
| 206086 | Junction sealing kit |
| Kicking strips | |
| 206148 | Frontal kicking strip for concrete installation, 800mm |
| 206150 | Frontal kicking strip for concrete installation, 1000mm |
| 206151 | Frontal kicking strip for concrete installation, 1200mm |
| 206152 | Frontal kicking strip for concrete installation, 1600mm |
| 206176 | Frontal kicking strip, 800mm (not for refr-freezer base) |
| 206177 | Frontal kicking strip, 1000mm (not for refr-freezer base) |
| 206178 | Frontal kicking strip, 1200mm (not for refr-freezer base) |
| 206179 | Frontal kicking strip, 1600mm (not for refr-freezer base) |
| 206249 | Pair of side kicking strips |
| 206265 | Pair of side kicking strips for concrete installation |



| PNC Code | Description |
|-------------------|---|
| Panels | |
| 206374 | Rear paneling - 800mm (700/900) |
| 206375 | Rear paneling - 1000mm (700/900) |
| 206376 | Rear paneling - 1200mm (700/900) |
| 216000 | 2 side covering panels for free standing appliances |
| Water taps | |
| 206291 | Water column extension for 700 line |



Technical specifications

Electric

| | |
|------------------|-------------------------------------|
| Supply voltage: | 380-400 V/3N ph/50/60 Hz |
| Total Watts: | 14.8 kW |
| Predisposed for: | 380-400V 3N~ 50/60Hz 13,6-14,8kW |

Key Information:

| | |
|----------------------------------|------------------------|
| Oven working Temperature: | 140 °C MIN; 300 °C MAX |
| Oven Cavity Dimensions (width): | 540 mm |
| Oven Cavity Dimensions (height): | 300 mm |
| Oven Cavity Dimensions (depth): | 650 mm |
| External dimensions, Width: | 800 mm |
| External dimensions, Depth: | 730 mm |
| External dimensions, Height: | 850 mm |
| Net weight: | 83 kg |
| Shipping weight: | 97 kg |
| Shipping height: | 1080 mm |
| Shipping width: | 820 mm |
| Shipping depth: | 860 mm |
| Shipping volume: | 0.76 m ³ |
| Certification group: | N7CIE |
| Front Plates Power: | 2.2 - 2.2 kW |
| Back Plates Power: | 2.2 - 2.2 kW |
| Front Plates dimensions: | Ø 230 Ø 230 |
| Back Plates dimensions: | Ø 230 Ø 230 |

Front

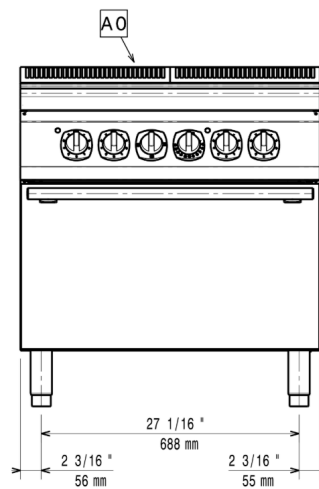

Side

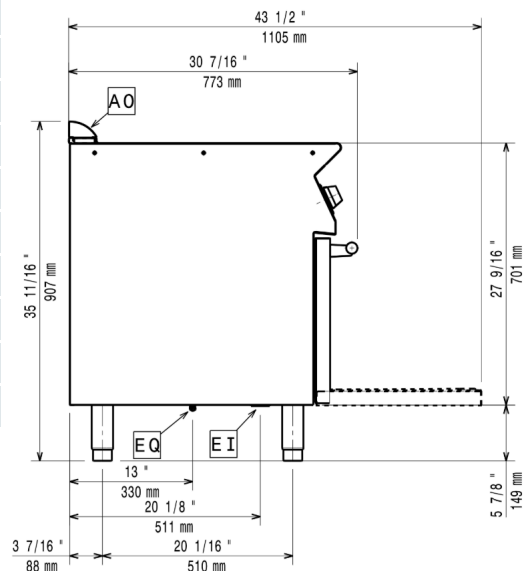

Top

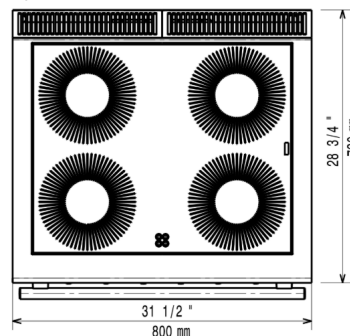

EI = Electrical inlet (power)

EQ = Equipotential screw



Find out more:
ISO Certificates
Electrolux Professional Recognitions

The company reserves the right to make modifications to the products without prior notice. All information correct at time of printing.

24/02/2026

4/4