

391088 (E9FREH2GF0)

15+15-lt electric Fryer with 2 "V" shaped wells (external heating elements), 2 baskets and lids included

Main Features

- All major compartments located in front of unit for ease of maintenance.
- Deep drawn V-Shaped wells.
- Overheat protection thermostat as standard on all units.
- The special design of the control knob system guarantees against water infiltration.
- Thermostatic regulation of oil temperature up to a maximum of 185 °C.
- Unit delivered with four 50 mm legs in stainless steel as standard (all round Stainless steel kick plates as option).
- Oil drains through a tap into a drainage container positioned under the well.
- Supplied as standard with 2 baskets and 1 right and left side doors for cupboard.
- External infrared heating elements for ease of cleaning of internal well.
- Interior of wells with seamlessly laser-welded corners for ease of cleaning.
- Optional portable oil quality monitoring tool (code 9B8081) for efficient oil management

Construction

- Model has right-angled side edges to allow flush fitting joints between units, eliminating gaps and possible dirt traps.
- IPX5 water resistance certification.
- All exterior panels in Stainless Steel with Scotch Brite finishing.
- Unit is 930 mm deep to give a larger working surface area.

Sustainability

- This model is compliant with Swiss Energy Efficiency Ordinance (730.02).

Included Accessories

PNC Code	Description	Quantity
206350	Door for open base cupboard	2
921691	1 full size basket for 14/15lt fryers	2



Optional Accessories

PNC Code	Description
Bases & base accessories	
206350	Door for open base cupboard
Baskets	
921691	1 full size basket for 14/15lt fryers
921692	2 half size baskets for 14/15lt fryers
Chimney upstands	
206304	Chimney upstand, 800mm
206400	Chimney grid net, 400mm (700XP/900)
Feet, wheels and ramps	
206135	Kit 4 wheels - 2 swivelling with brake - it is mandatory to install Base support and wheels
206136	Flanged feet kit
206210	Kit 4 feet for concrete installation (not for 900 line free standing grill)
206367	Base support for feet or wheels - 800mm (700/900)
206368	Base support for feet or wheels - 1200mm (700/900)
206369	Base support for feet or wheels - 1600mm (700/900)
206370	Base support for feet or wheels - 2000mm (700/900)
Grease/oil management	
206235	Sediment tray for 15lt fryers
206301	Oil drain pipe for 15lt free standing fryer
921693	Filter for fryer oil collection basin for 7lt, 14lt, 15lt free standing fryers
921695	Unclogging rod for 15lt fryers drainage pipe
921696	Deflector for floured products for 15lt fryers
Handrails	
206308	Back handrail 800 mm
206309	Back handrail 1200 mm
Installation solutions	
206086	Junction sealing kit
Kicking strips	
206148	Frontal kicking strip for concrete installation, 800mm
206150	Frontal kicking strip for concrete installation, 1000mm
206151	Frontal kicking strip for concrete installation, 1200mm
206152	Frontal kicking strip for concrete installation, 1600mm
206157	Pair of side kicking strips for concrete installation
206176	Frontal kicking strip, 800mm (not for refr-freezer base)
206177	Frontal kicking strip, 1000mm (not for refr-freezer base)
206178	Frontal kicking strip, 1200mm (not for refr-freezer base)
206179	Frontal kicking strip, 1600mm (not for refr-freezer base)



PNC Code	Description
Kicking strips	
206180	Pair of side kicking strips (not for refr-freezer base)
Panels	
206181	2 panels for service duct for single installation
206202	2 panels for service duct for back to back installation
206374	Rear paneling - 800mm (700/900)
206375	Rear paneling - 1000mm (700/900)
206376	Rear paneling - 1200mm (700/900)
216134	2 side covering panels for free standing appliances



Technical specifications

Electric

Supply voltage:	380-400 V/3N ph/50-60 Hz
Total Watts:	20 kW
Predisposed for:	
Key Information:	
Usable well dimensions (width):	240 mm
Usable well dimensions (height):	505 mm
Usable well dimensions (depth):	380 mm
Well capacity:	13 lt MIN; 15 lt MAX
Thermostat Range:	105 °C MIN; 185 °C MAX
Net weight:	86 kg
Shipping weight (gross):	99 kg
Shipping height:	1080 mm
Shipping width:	1020 mm
Shipping depth:	880 mm
Shipping volume:	0.97 m ³
Certification group:	EFE92M15

Front

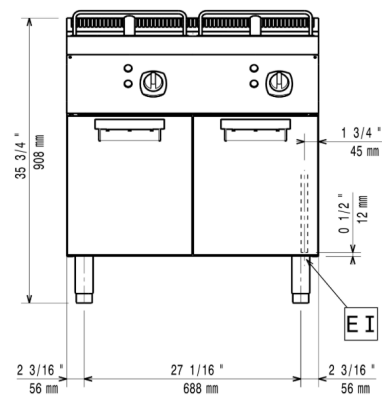

Side

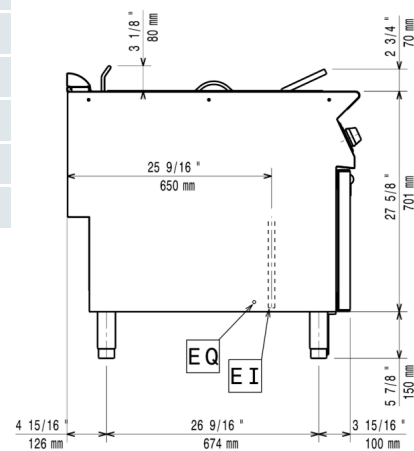

Top

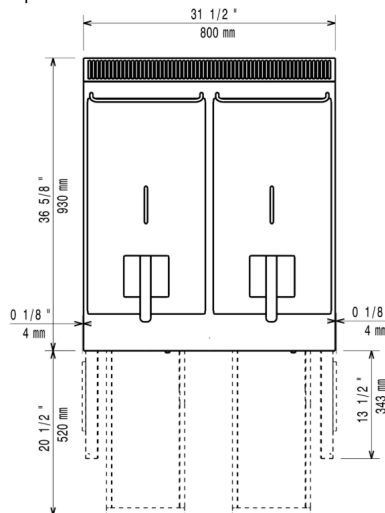

EI = Electrical inlet (power)

EQ = Equipotential screw

DO = Overflow drain pipe



Find out more:
ISO Certificates
Electrolux Professional Recognitions

The company reserves the right to make modifications to the products without prior notice. All information correct at time of printing.

2026/05/31